

# GET IN THE SEAT

at Green Diamond Equipment

## 1 Series Compact Tractor

**0%** FINANCING  
for 84 months\*

**1023E** 21.5 HP  
Includes  
120R Loader

Lease  
**\$219** /month  
+tax  
60 months\*

Yanmar 3 cylinder engine  
Hydrostatic transmission  
Power steering  
Turf or industrial  
tire options

## X300 Select Series Lawn Tractor

Hydrostatic transmission  
Twin Touch™ foot control  
Accel Deep™ Deck

**X330** 22 HP  
Briggs & Stratton  
cyclonic engine  
Dual blades  
42" mower

**\$5,099** +tax

**4 YEAR/300 Hour  
BUMPER TO BUMPER  
WARRANTY\*\***

**FINANCE  
1.9%**  
for 36 months\*  
X300 Select Series

Your Maritime John Deere Dealer

[www.green-diamond.ca](http://www.green-diamond.ca)



\*Term limited to years or hours used, whichever comes first, and varies by model. See the LIMITED WARRANTY FOR NEW JOHN DEERE TURF AND UTILITY EQUIPMENT at JohnDeere.com or JohnDeere.ca/TUWarranty for details.)

# Lawn Tractors

**9** months **NO PAYMENT**  
**NO INTEREST\***  
S100 Series Lawn Tractors



S130

Prices do not include tax.

Model	HP	Cylinders	Width	Blades	Price
S100	17.5	Single	42"	Dual	\$3,549
S110	19	Single	42"	Dual	\$3,649
S120	22	V-twin	42"	Dual	\$3,949
S130	22	V-twin	42"	Dual	\$4,049
S140	22	V-twin	48"	Triple	\$4,049
S160	24	V-twin ELS	48"	Triple	\$4,449
S170	24	V-twin ELS	48"	Triple	\$4,549
S180	24	V-twin ELS	54"	Triple	\$5,049

Easy Oil Change on these models



S140

## S100 Series Lawn Tractor

Briggs & Stratton engine  
Hydrostatic transmission  
with Twin Touch™ foot control  
Spring-assisted hand grip lever raises and lowers deck easily  
Operator station is wide and comfortable

**2 YEAR/120 Hour**  
**BUMPER TO BUMPER**  
**WARRANTY\*\***

See back cover for Green Diamond Equipment Locations.



S220 22 HP V-twin dual blades, 42" mower \$4,249<sup>+tax</sup>

## S200 Sport Lawn Tractor

V-twin engine  
Hydrostatic transmission  
Accel Deep™ Deck  
Twin Touch™ foot control

**3 YEAR/200 Hour**  
**BUMPER TO BUMPER**  
**WARRANTY\*\***

Model	HP	Cylinders	Width	Blades	Price
S220	22	V-twin-B&S	42"	Dual	\$4,249
S240	21.5	V-twin-Kaw	42"	Dual	\$4,849
	21.5	V-twin-Kaw	48"	Triple	\$5,249

**Buy 9 Months**  
**NO PAYMENT** OR **4.9%**  
**NO INTEREST\*** for 60 Months\*

Series: S200, Z300, Z500, X300, X500, X700

Twin Touch™ foot control with a hydrostatic transmission, allows effortless direction and speed changes without clutching.



## X300 Select Series

Kawasaki V-twin engine (except X330)  
Hydrostatic transmission  
Twin Touch™ foot control

**4 YEAR/300 Hour**  
**BUMPER TO BUMPER**  
**WARRANTY\*\***

Accel Deep™ Deck

**Order today!**



X330 22 HP \$5,099<sup>+tax</sup>  
Briggs & Stratton cyclonic engine  
Dual blades, 42" mower

Model	HP	Width	PS	PL	Tilt	4W Steer	Price
X330	22	42"					\$5,099
	22	48"					\$5,899
X350	21.5	42"					\$5,399
	21.5	48"					\$6,199
X354	21.5	42"				✓	\$6,699
X350R	21.5	42"					\$8,099
X370	21.5	42"	✓	✓			\$6,899
X380	23	48"					\$7,499
	23	54"					\$7,899
X384	23	48"				✓	\$8,899
X390	23	48"	✓	✓	✓		\$9,099
	23	54"	✓	✓	✓		\$9,499
X394	23	48"	✓	✓	✓	✓	\$10,199

\*\*Term limited to years or hours used, whichever comes first, and varies by model. See the LIMITED WARRANTY FOR NEW JOHN DEERE TURF AND UTILITY EQUIPMENT at JohnDeere.com or JohnDeere.ca/TUWarranty for details.)

# X500 Select Series Lawn Tractor



Heavy duty transmission systems and standard traction control

**4 YEAR/500 Hour  
BUMPER TO BUMPER  
WARRANTY\*\***

# Lawn Tractors



**X570**  
24 HP  
48" Accel Deep™ Mower  
Twin Touch™ foot control

**\$10,599**<sup>+tax</sup>

Model	HP	Width	PS/PL	HDAP	Tires	Price
X570	24	48"				\$10,599
	24	54"				\$10,999
X580	24	54"	✓	✓		\$12,329
X590	25.5	54"	✓	✓		\$13,599

**Buy 9 Months  
NO PAYMENT  
NO INTEREST\*** OR **1.9%** for 36 Months\*  
X500 Select Series

# X700 Signature Series

Buy **4.9%** for 60 months\*



**X730 25.5 HP \$16,799**<sup>+tax</sup>  
Twin Touch™ foot control

Model	HP	Cylinders	PS/PL	EFI	L/C	4WD	4W Steer	Price
X730	25.5	V-twin Kaw	✓	✓	✓			\$16,799
X734	25.5	V-twin Kaw	✓	✓	✓		✓	\$18,399
X738	25.5	V-twin Kaw	✓	✓	✓	✓		\$18,999
X739	25.5	V-twin Kaw	✓	✓	✓	✓	✓	\$20,199
X750	24	3 Cyl Diesel	✓		✓			\$18,599
X754	24	3 Cyl Diesel	✓		✓		✓	\$20,099
X758	24	3 Cyl Diesel	✓		✓	✓		\$20,599

**4 YEAR /700 Hour  
BUMPER TO BUMPER  
WARRANTY\*\***

Mower decks not included at above prices. 48", 54" and 60" mowers available.

# Air cooled engine ZTrak Zero Turn Mowing



Fuel tank with guage

**Z315E 20HP \$4,799**<sup>+tax</sup>  
42" Accel Deep™ Mower

## BUMPER TO BUMPER WARRANTY\*\*

Model	HP	Cylinders	Speed	Width	Accel™	Years	Hours	Price
Z315E	20	V-twin B&S	11.3 km/h	42"	✓	3	200	\$4,799
Z325E	24	V-twin B&S	11.3 km/h	48"	✓	3	200	\$5,199
		V-twin B&S	11.3 km/h	54"	✓	3	200	\$5,399
Z320M	21.5	V-twin	11.3 km/h	42"	✓	3	200	\$4,999
Z330M	23	ELS V-twin	11.3 km/h	48"	✓	3	200	\$5,299
		ELS V-twin	11.3 km/h	54"	✓	3	200	\$5,399
Z320R	21.5	V-twin B&S	11.3 km/h	42"	✓	3	200	\$5,199
Z330R	23	V-twin	11.3 km/h	48"	✓	3	200	\$5,599
		V-twin	11.3 km/h	54"	✓	3	200	\$5,699
Z515E	24	ELS V-twin	12.9 km/h	48"	✓	4	300	\$6,999
		ELS V-twin	12.9 km/h	54"	✓	4	300	\$7,299
		ELS V-twin	12.9 km/h	60"	✓	4	300	\$7,699
Z530M	24	V-twin	12.9 km/h	48"	✓	4	300	\$7,799
		V-twin	12.9 km/h	54"	✓	4	300	\$8,099
		V-twin	12.9 km/h	60"	✓	4	300	\$8,499
Z530R	24	V-twin	14.5 km/h	54"	HC Deck	4	500	\$8,699
		V-twin	14.5 km/h	60"	HC Deck	4	500	\$9,099
Z545R	25	V-twin EFI	14.5 km/h	48"	HC Deck	4	500	\$9,299
		V-twin EFI	14.5 km/h	54"	HC Deck	4	500	\$9,499
		V-twin EFI	14.5 km/h	60"	HC Deck	4	500	\$9,899
Z720E	23	V-twin	12.9 km/h	48"	ProDeck	4	500	\$10,899
		V-twin	12.9 km/h	54"	ProDeck	4	500	\$11,399
		V-twin	12.9 km/h	60"	ProDeck	4	500	\$11,799
Z735E	25	V-twin	12.9 km/h	60"	ProDeck	4	500	\$12,099
Z730M	24	V-twin	15.3 km/h	54"	ProDeck	4	750	\$13,099
		V-twin	15.3 km/h	60"	ProDeck	4	750	\$13,599
Z735M	25	V-twin	15.3 km/h	48"	ProDeck	4	750	\$12,399
		V-twin	15.3 km/h	54"	ProDeck	4	750	\$12,899
		V-twin	15.3 km/h	60"	ProDeck	4	750	\$13,299
Z740R	23.5	V-twin	16.1 km/h	48"	ProDeck	4	1,000	\$14,399
		V-twin	16.1 km/h	54"	ProDeck	4	1,000	\$14,899
		V-twin	16.1 km/h	60"	ProDeck	4	1,000	\$15,299
Z760R	27	V-twin	16.1 km/h	54"	ProDeck	4	1,000	\$15,399
		V-twin	16.1 km/h	60"	ProDeck	4	1,000	\$15,899

# Z370R Electric ZTrak™ Zero-Turn Mower



**3 YEAR /200 HOUR  
BUMPER TO BUMPER WARRANTY\*\***  
No noise. No gas needed.  
Zero operating emissions  
42" \$8,575<sup>+tax</sup> 48" \$9,245<sup>+tax</sup>

To order, contact your local Green Diamond Equipment.

# PARTS & SERVICE

## Lawn Tractor Attachments

Let your lawn tractor do the work!

Setup for \$50 (Sweepers \$80)

Take advantage of  
**NO PAYMENT/  
 NO INTEREST**  
 for **120 Days**<sup>®</sup>  
 on purchases over \$250 on your  
**Multi-Use Account**

Apply online for a quick response:  
[www.deere.com/en/finance/financing/application/multi-use-account](http://www.deere.com/en/finance/financing/application/multi-use-account)  
 Plan #11368



Prices do not include tax.

### Poly Carts

10P Poly Cart  
 LPPCT10JD  
**\$479<sup>99</sup>**



17P Poly Cart LPPCT17JD **\$729<sup>99</sup>**

7P Poly Cart  
 LP21935 **\$399<sup>99</sup>**



36" Lawn Roller LPPRT36JD **\$329<sup>99</sup>**

Spin  
 Spreader LP25353 Pull 125lb **\$599<sup>99</sup>**  
 LP25354 Pull 175 lb **\$689<sup>99</sup>**



Broadcast Spreader  
 LPBS36JD 3.5 CuFt **\$479<sup>99</sup>**



Sweeper  
 LPSTS42JD **\$774<sup>99</sup>**



### Plug Aerator

40" Plug Aerator LPPA40JD **\$759<sup>99</sup>**  
 48" Plug Aerator LPPA48JD **\$939<sup>99</sup>**



### Steel Carts

13 Steel LPHDC13JD **\$899<sup>99</sup>**  
 18 Steel LPHDC18JD **\$1,199<sup>99</sup>**



### Weights

for all John Deere Lawn Tractors  
 UC13263 **\$111<sup>25</sup>** each



### Spike Aerator

40" LPSAT40JD **\$549<sup>99</sup>**



### Home Maintenance Kits

Starting at **\$59<sup>99</sup>**



### Material Collection Systems for most John Deere Lawn Tractors and Ztraks

Contact your Green Diamond Equipment for pricing on specific models



Thatcherator  
 40" LPTA40JD **\$385<sup>99</sup>**

[www.green-diamond.ca](http://www.green-diamond.ca)

# PARTS & SERVICE

## Lawn Tractor & Residential ZTrak Preventative Maintenance Packages

- Oil
  - Oil Filter
  - 6 Point Inspection
- starting at **\$165<sup>99</sup>** +tax  
100 Series (S, E, L, LA and D)

### Diamond Package

- Oil • Oil Filter • 6-Point inspection
- 100 Series (S, E, L, LA and D) **\$165<sup>99</sup>\*** /VGDP100  
(Quick change filter models add \$30)

X Series and ZTraks **\$181<sup>99</sup>\*** /VGDPX  
Does not include Professional Series

### Double Diamond Package

- Oil • Oil Filter • Fuel Filter
  - Spark plug(s) • Blade Sharpening
  - Deck cleaning • Deck Levelling
  - 6-Point inspection
- 100 Series (S, E, L, LA and D) **\$282<sup>99</sup>\*** /VGDDP100  
(Quick change filter models add \$30)

X Series and ZTraks **\$295<sup>99</sup>\*** /VGDDPX  
Does not include Professional Series

### Triple Diamond Package

The Double Diamond Package PLUS the work is done at your home, or equipment will be picked up and delivered back.

100 Series (S, E, L, LA and D) **\$364<sup>99</sup>\*\*** /VGTDP100  
(Quick change filter models add \$30)

X Series and ZTraks **\$379<sup>99</sup>\*\*** /VGTDPX  
Does not include Professional Series



Regular maintenance ensures problem free performance and preserves your equipment value.



\*Prices do not include tax. 6 months parts and labour warranty on all OEM dealer installed turf parts. Air filters will be checked and cleaned, if needing to be replaced additional charges will apply. Prices subject to change without notice.  
\*\*In select stores, within a 30km radius. Please check store for this service and additional charges outside this distance.

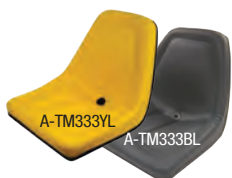

Replacement Seat  
**\$99<sup>99</sup>**



Many sizes in stock

PERFORMANCE Batteries  
Starting at **\$97<sup>20</sup>**  
with old battery trade-in



Standard Lawn Tractor Cover LP93917 **\$94<sup>99</sup>**



Riding Mower Seat Cover  
11" LP22704 **\$35<sup>99</sup>**  
15" LP92324 **\$36<sup>99</sup>**

## Power Tool SERVICE

### INCLUDES:

- Sparkplug Replacement
- Tune Carb
- Clean-up
- Sharpen/Replace, Cutter/ Chain\*
- Replace trimmer line
- Clean/Replace Air Filter\*
- Check/Replace Fuel Filter\*



ONLY **\$64<sup>95</sup>** +tax



\*Air filters, chains, cutter and fuel filters will be checked and cleaned, if needing to be replaced, additional charges will apply. Price subject to change without notice.

# Compact Tractors

# Finance

## 1 Series

Yanmar 3 cylinder engine  
Hydrostatic transmission  
Power steering  
Turf or industrial  
tire options

# 0%

for 84 months\*  
Compact Tractors  
1, 2, 3D and 3E Series



1023E 21.5 HP Includes 120R Loader

Lease  
**\$219**  
/month +tax  
60 months\*

**6-YEAR  
2,000 HOUR  
LIMITED POWERTRAIN  
WARRANTY<sup>1</sup>**



1025R 23.9 HP  
Includes 120R Loader  
and 54D Mower

Lease  
**\$324**  
/month +tax  
60 months\*

1025R 23.9 HP  
Includes  
120R Loader  
and Mauser  
Cab



Lease  
**\$359**  
/month +tax  
60 months\*

1025R 23.9 HP  
Includes 120R Loader  
and 260B Backhoe

Lease  
**\$359**  
/month +tax  
60 months\*



No tools needed  
to attach or  
remove  
implements!



## Come in for a demo!

## 2R Series

Yanmar 3 cylinder  
engine  
Hydrostatic  
transmission with  
TwinTouch™ pedals  
Cruise control  
Power Steering  
Turf or industrial  
tire options

2025R 23.9 HP  
Includes 120R Loader  
54D Mower, Radial Tires

Lease  
**\$315**  
/month +tax  
60 months\*



2032R 31.2 HP  
Includes 220R Loader

Lease  
**\$389**  
/month +tax  
60 months\*

2038R 37.3 HP  
Includes 220R Loader

Lease  
**\$410**  
/month +tax  
60 months\*

# 3D Series Compact Tractors

Yanmar 3 cylinder engine  
8F/8R, gear drive transmission  
Powerful, standard 2000 kg (4409 lb) hauling capacity  
Heavy-duty drivetrain  
4 wheel drive  
Category 1, 3 point hitch



**3025D 24.7 HP**

Includes 300E Loader

Lease **\$330** /month +tax  
60 months\*

**3035D 34.7 HP**

Includes 300E Loader

Lease **\$385** /month +tax  
60 months\*

**3043D 42.2 HP**

Includes 300E Loader

Lease **\$425** /month +tax  
60 months\*

Finance

**0%**  
for 84 months\*  
Compact Tractors  
1, 2, 3D and 3E Series

# 3E Series

**6-YEAR  
2,000 HOUR  
LIMITED POWERTRAIN  
WARRANTY<sup>1</sup>**

Yanmar 3 cylinder engine  
Hydrostatic transmission 2 range  
Twin Touch™ foot control  
Power steering



**3025E 24.7 HP** Includes 300E Loader

Lease **\$355** /month +tax  
60 months\*

**3032E 31.2 HP**  
Includes  
300E Loader

Lease **\$382** /month +tax  
60 months\*



No tools needed to attach or remove implements!

**3038E 37.3 HP**  
Includes  
300E Loader

Lease **\$419** /month +tax  
60 months\*



**JOHN DEERE**



**Green DIAMOND**  
EQUIPMENT™

# Compact Tractors

**6-YEAR LIMITED POWERTRAIN WARRANTY\***  
2,000 HOUR

## 3R Series

Yanmar 3 cylinder engine • Final tier 4 compliant  
Hydrostatic transmission • 3 Range • Power Steering

**3033R** 32.2 HP  
Includes Cab  
and 320R Loader

Lease  
**\$610**  
/month +tax  
60 months\*

**3039R** 38.8 HP  
Includes Cab and  
320R Loader

Lease  
**\$642**  
/month +tax  
60 months\*

**3046R**  
45.3 HP Includes Cab and 320R Loader

Lease  
**\$680**  
/month +tax  
60 months\*



## TRACTORPLUS SMART CONNECTOR INSTALL



**TractorPlus**  
John Deere

For models ranging from 2032R to 4066R

The New John Deere TractorPlus Smart Connector is the latest and greatest technology to connect your machine to your smartphone using Bluetooth connection. Take the guesswork out of equipment maintenance by using the TractorPlus™ App and Smart Connector to recommend service intervals, view diagnostic codes and more.

starting at **\$224<sup>99</sup>**  
includes parts and labour  
/Tractor SC install

## Preventative Maintenance Packages

### 1 and 2 Series Compact Tractors



**Maintenance Service** /compact Oil & Fuel

- Change engine oil and oil filter
- Replace fuel filters
- 20+ point general walk around inspection

Starting at **\$294<sup>99</sup>†**



**Complete Service** /compact full serv

- Engine oil & filter
- Fuel filters
- Transmission/ hydraulic filter
- Check & clean air filter
- Check front end oil level
- Grease chassis & loader
- 20+ point general walk around inspection

Starting at  
**\$484<sup>99</sup>†**

† Price may vary based on model. Additional charges will apply if hydraulic oil needs to be changed on all packages. Service at customer location will have service call and travel charge added. Prices are subject to change without notice.



**JOHN DEERE**



**Green DIAMOND**  
EQUIPMENT™



# Compact Tractor IMPLEMENTS

Prices do not include tax.

## Steel Broadcast Spreaders

226 lb Spreader  
SS1023B  
\$1,650

362 lb Spreader SS1036B \$1,700  
678 lb Spreader SS1067B \$1,800

## Grooming Mowers

48" Grooming Mower GM1048E \$5,100

60" Grooming Mower GM1060E \$5,300<sup>00</sup>

72" Grooming Mower GM1072E \$5,800<sup>00</sup>

Prices shown do not include cutting PTO shaft.

# 120 DAYS

## NO PAYMENT NO INTEREST

### on all Frontier Attachments

OAC with a John Deere Financial Multi-Use Account

## STD Rear Blades

Category 1

60" Rear Blade RB2060L \$1,090  
60" Rear Blade RB2060 \$1,400  
60" Rear Blade RB5060 \$1,500  
72" Rear Blade RB2072 \$1,550  
84" Rear Blade RB2084 \$1,650

## STD Rear Box Blades

48" Box Blade BB5048L \$1,550  
48" Box Blade BB2048 \$1,900  
60" Box Blade BB5060L \$1,700  
60" Box Blade BB5060 \$2,000  
60" Box Blade BB2060 \$2,000  
65" Box Blade BB2065 \$2,200  
72" Box Blade BB2072 \$2,300

## Rotary Tillers

49" Rotary Tiller RT3049 \$4,000  
49" Rotary Tiller RT3049R \$4,600  
62" Rotary Tiller RT3062 \$4,400  
62" Rotary Tiller RT3062R \$4,900  
73" Rotary Tiller RT3073 \$5,000  
73" Rotary Tiller RT3073R \$5,300

Prices shown do not include cutting PTO shaft.  
The letter R after the product number indicates reverse rotating tines.

## STD Landscape Rakes

60" Landscape Rake LR5060L \$1,400  
60" Landscape Rake LR5060 \$1,500  
60" Landscape Rake LR2060L \$1,500  
72" Landscape Rake LR2072 \$1,700  
84" Landscape Rake LR2084 \$1,900

# FRONTIER

# Add more Do more

with John Deere Attachments for Compact Tractors



**Rear Wiper Kit**  
BLV11241 \$564<sup>10</sup>  
1 Series

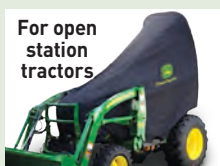

**For open station tractors**  
**Tractor Cover**  
LP95637 \$221<sup>75</sup>  
1, 2, and 3 Series



**Quick Hitch**  
\*QHIG \$399<sup>99</sup> Compatible  
with 1, 2, 3 and 4 Series



**iMatch Bushing Kit**  
LP19969 \$55<sup>43</sup>  
1 Series



**Single Rear Auxiliary Work Light** LVB25547  
\$111<sup>30</sup> 1, 3D and 3E Series



**Dual Light - Forward Lighting Kit** LVB25546  
\$189<sup>05</sup> 2, 3D and 3E Series



**Quick-Tatch Weight**  
42LB UC13263 \$111<sup>25</sup>  
1, 3D and 3E Series

**Unlock potential** with every implement and attachment.

Save time and effort on those heavy duty tasks.

## John Deere Attachments for 2 Series Compact Tractors



**Wheel Spacer Kit**  
(60mm each side)  
BLV10430 \$558<sup>00</sup> 2 Series



**Rear Wiper Kit**  
BXX10309 \$594<sup>59</sup>  
2 Series



**Standard Canopy**  
LVB25334 \$1,040<sup>35</sup>  
2 Series



**Rear LED Worklight**  
BLV11083 \$176<sup>85</sup>  
2 Series

## John Deere Attachments for 3R and 4R Compact Tractors

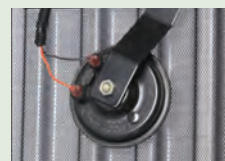

**Horn Kit Cab Only**  
LVB24851 \$71<sup>66</sup>  
3R Series

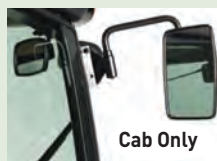

**External Mirror Kit**  
LVB24844 \$356<sup>76</sup>  
3R Series



**Deluxe Hood Guard**  
BW16585 \$1,058<sup>07</sup>  
3R Series



**Rear Wiper Kit**  
LVB24856 \$440<sup>61</sup>  
3R and 4R Series



**Beacon Light Kit**  
LVB24852 \$457<sup>38</sup>  
3R and 4R Series



**Rear Worklights Kit**  
LVB24853 \$283<sup>58</sup>  
3R and 4R Series



**Backup Alarm Kit**  
BLV10648 \$228<sup>69</sup>  
3R and 4R Series



**Rear Wheel Weights**  
T19293 \$265<sup>28</sup>  
3R and 4R Series

## John Deere Attachments for 5E Series Compact Tractors



**Telescopic Mirror**  
AL80126 \$307<sup>97</sup>  
5E Series



**Telescopic Mirror**  
AL80127 \$307<sup>97</sup>  
5E Series



**Auxiliary Cab Work Light** LVB25720 \$215<sup>17</sup>  
5E Series



**Hood Guard**  
starting at \$734<sup>86</sup>  
5E Series

An efficient 24/7 solution  
for our busy customers



SALES • PARTS • SERVICE • ACCOUNTS

Access your transactions,  
order parts, pay invoices,  
request service, view guides  
and browse equipment.

Anytime. Anywhere.

Sign up now to get access to  
Diamond CONNECT using your  
phone, tablet or computer.  
Go to: [www.green-diamond.ca](http://www.green-diamond.ca)

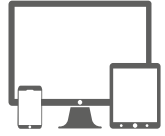

## John Deere Quality Toys for All Ages!

Ground Force  
Tractor with trailer  
12 volt  
LP49517  
\$439<sup>99</sup>

Motorized  
Fun!

Gator XUV with trailer  
12 volt LP49518 \$599<sup>99</sup>  
For 2 riders

Heavy Duty  
16" Bicycle  
TBEK35016 Age 4+  
\$179<sup>99</sup>



For Ages 3-8  
2-speeds (2.5 to 5 mph)  
plus Reverse

Big Loader  
Johnny  
Tractor Age 3+  
LP70562 \$54<sup>99</sup>

15" Big Scoop  
Dump Truck and  
Sand Tools LP64760

\$34<sup>99</sup>

1:64 Dairy  
Barn Play Set  
TBEK12279 \$38<sup>99</sup>



20" Bike TBEK35623  
Green \$239<sup>99</sup>

Inventory  
varies by  
location. Prices do not include tax.

Green Diamond Equipment is your authorized dealer for STIHL®

SHOP LOCAL. BUY STIHL.

BG 50  
GAS HANDHELD  
BLOWER



SAVE \$40  
\$199<sup>99</sup>

27.2 CC • 0.7 KW • 3.6 KG / 7.9 LB

MSRP \$239.99

BATTERY POWER. MADE BY STIHL.

BGA 45  
BATTERY BLOWER



SAVE \$50  
\$149<sup>99</sup>

18 V LITH-ION • 36 WH • 4.4 LB

MSRP \$199.99

RMA 460 (SET)  
BATTERY  
LAWN MOWER



\$699<sup>99</sup>

19" DECK • AK 30 • AL 101 • 61.8

MSRP  
Price includes battery  
and charger.

FS 40 C-E  
GAS TRIMMER



SAVE \$30  
\$249<sup>99</sup>

27.2 CC • 0.7 KW • 4.5 KG / 9.9 LB

MSRP \$279.99

RE 80 ELECTRIC  
PRESSURE  
WASHER



SAVE \$40  
\$199<sup>99</sup>

120 V • 1.450 PSI • 1.89 GPM

MSRP \$239.99

KM 56 RC-E  
GAS KOMBISYSTEM

27.2 CC • 0.8 KW • 4.3 KG / 9.5 LB

Easy 2 Start

SAVE \$30  
\$299<sup>99</sup>

MSRP \$329.99

KM 56 RC-E with FS-KM  
Line Head Trimmer  
KombiTool as shown  
\$439<sup>98</sup>

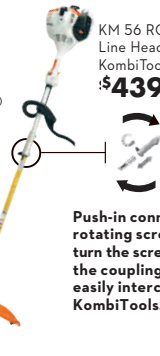

Push-in connection with  
rotating screw. Simply  
turn the screw to release  
the coupling sleeve to  
easily interchange  
KombiTools.

THE RIGHT TOOL FOR EVERY JOB.  
15 KOMBITOOLS STARTING AT ONLY \$109<sup>99</sup>

- |   |   |   |  |
|---|---|---|--|
| <p>\$109<sup>99</sup><br/>CURVED SHAFT<br/>TRIMMER FSB-KM<br/>4137 740 5008</p>     | <p>\$149<sup>99</sup><br/>BRUSHCUTTER<br/>FS-KM<br/>4180 200 0478</p>     | <p>\$184<sup>99</sup><br/>BLOWER<br/>BG-KM<br/>4606 740 5000</p>      | <p>\$159<sup>99</sup><br/>CURVED SHAFT LAWN<br/>EDGER FCB-KM<br/>4180 740 5002</p> |
| <p>\$249<sup>99</sup><br/>STRAIGHT HEDGE<br/>TRIMMER HL-KM 0*<br/>4245 740 5000</p> | <p>\$299<sup>99</sup><br/>MINI CULTIVATOR<br/>BF-KM<br/>4601 740 5000</p> | <p>\$299<sup>99</sup><br/>POLE PRUNER<br/>HT-KM<br/>4182 200 0211</p> | <p>\$499<sup>99</sup><br/>STIHL POWERSWEEP™<br/>KW-KM<br/>4601 740 4904</p>        |

All KombiTools sold separately. Not all KombiTools shown.

Dealers may sell for less. Pricing on all products and accessories will remain in effect until June 28, 2024. Illustrations and descriptions are as accurate as known at the time of publication and are subject to change without notice. STIHL Limited is not responsible for a printing error, the local STIHL Dealer has the final authority to set product pricing. Pricing valid at participating dealers only while supplies last.

# Your Maritime John Deere Dealer



**100 Certified Technicians**  
**\$20 Million on-hand parts**  
**65 Professional Parts Sales Staff**

[www.green-diamond.ca](http://www.green-diamond.ca)



## Nova Scotia

### Middleton

166 Junction Road,  
Middleton  
902-825-3042  
866-379-9428 (toll free)

### Kentville

1105 Hwy 359,  
Kentville  
902-678-5555  
866-898-8370 (toll free)

### Halifax

270 Horseshoe Lake Dr.,  
Halifax  
902-450-0712  
855-450-0712 (toll free)

### Upper Onslow

53 Hub Centre Drive,  
Upper Onslow  
902-662-2516

### New Glasgow

5425 Highway #4,  
New Glasgow  
902-396-4125

### Antigonish

15 Haley Road,  
Antigonish  
902-863-5991

### Membertou

130 Kenikala Cres.,  
902-539-4673

## New Brunswick

### Grand Falls

67 Ouellette St,  
Grand Falls  
506-473-6963

### Woodstock

141 Heller Road,  
Woodstock  
506-325-6150  
866-771-3999 (toll free)

### Sussex

70 Aiton Rd., Sussex  
506-432-6470  
866-787-6470 (toll free)

### Moncton

70 Commerce Street,  
Moncton  
506-388-3337  
866-991-3337 (toll free)

### Miramichi

11413 Route 11, Napan  
506-773-6013

## Prince Edward Island

### Summerside

15 Locke Shore Road,  
Summerside  
902-436-4244  
800-716-4244 (toll free)

### Stratford

237 Mason Road,  
Stratford  
902-569-2500

### Bloomfield

41 Griffin Drive, Alberton  
902-853-2535

**Offers valid from May 1, 2024 to July 31, 2024.** 16 Year Power Train Warranty: Beginning 1/1/2016 on all Compact Utility Tractors purchased new from an authorized John Deere dealer come standard with 6 year/2000-hour (whichever comes first) Powertrain Warranty. See the Limited Warranty for New John Deere Turf & Utility Equipment at dealer for details. Offers subject to change without notice. Limited quantity available. Offers in flyers subject to availability and may be discontinued or modified. Taxes, set-up, delivery freight and preparation charges will apply. Down payment may be required. Monthly payments/cost of borrowing will vary depending on amount borrowed/down payment. Minimum finance amount may be required; representative amount does not guarantee offer applies. The charge for amounts past due is 24% per annum. Dealers are free to set individual prices. Additional dealer fees may apply. Financing on approved John Deere Financial credit only. Discounts or incentives may be available for cash purchases. By selecting the purchase finance offer, consumers may be foregoing such discounts and incentives which may result in a higher effective interest rate. Prices subject to change without notice. See dealer for complete details on lease and financing options. Some restrictions apply. Lease agreements must be through John Deere Financial. For all lease and finance options contained herein some restrictions apply. See dealer for details.

This is an advertisement of Green Diamond Equipment, an independently owned and operated dealership of John Deere Canada ULC products. Any representations made in this advertisement are those solely of Green Diamond Equipment and have not been authorized or permitted to be made by or on behalf of any other John Deere dealer, John Deere Canada ULC or its affiliates.

John Deere's green and yellow colour scheme, the leaping Deer symbol and JOHN DEERE are trademarks of Deere & Company. The trade-marks used are trademarks of Deere & Company, used by Green Diamond Equipment under license. © Copyright 2023 [John Deere Canada ULC]. All rights reserved."